



SPARKING POGO STICK



User Manual

**Read this entire manual before using the product.
For assistance, please contact Radio Road at
www.radioroadtoys.com**

DO NOT RETURN TO STORE

**Ages 9+
Max Weight: 160 lbs. (72 kg.)**

We make every effort to present the most current specifications and product features when printing this manual. As a result of our continual improvement, changes may be made to equipment, specifications and features without notice.

POGO PARTS

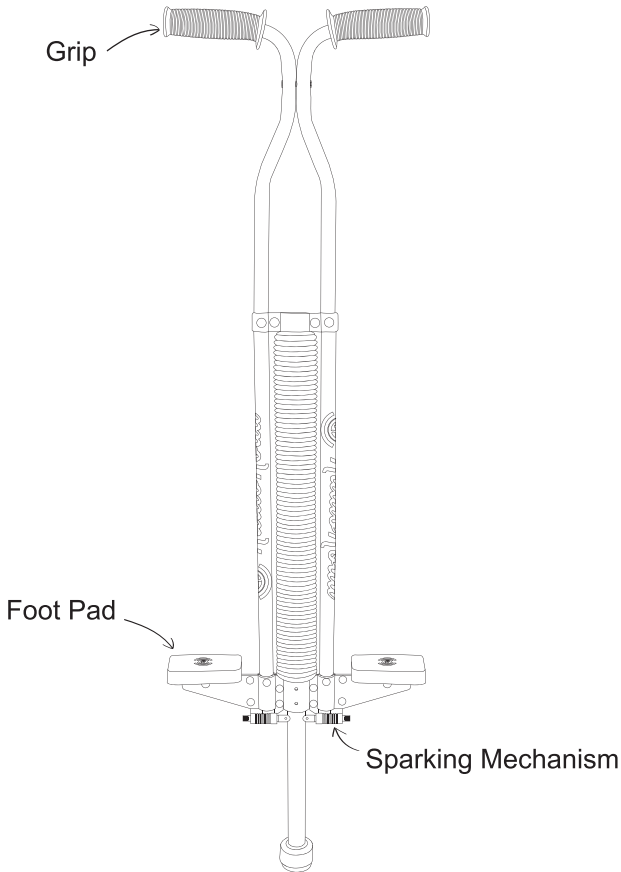

Contains (1) Pogo Stick	
Product Dimensions	
41" x 11.5" x 2.4"	104.2cm x 29.2cm x 6.1cm
6.48 lbs	2.94kg

SAFETY

WARNING

Be sure to read and follow the assembly instructions before assembling and using the product.

1. This product is intended for users ages 9+.
2. Maximum user weight is 160 lbs. (72 kg).
3. Always wear safety equipment such as helmet, knee pads, and elbow pads.
4. Always wear a helmet when using your pogo and keep the chinstrap securely buckled.
5. Always wear shoes.
6. Use on smooth, paved surfaces away from motor vehicles.
7. Avoid sharp bumps, drainage grates, and sudden surface changes.
8. Avoid streets and surfaces with water, sand, gravel, dirt, leaves, and other debris. Wet weather impairs traction and visibility.
9. Do not use at night.
10. Sparking mechanism will get hot from continuous use. Do not touch after using.
11. Avoid excessive jumping on downhill environments.
12. Adults must assist children in the initial adjustment procedures to use the pogo, adjust or replace the flints in the sparking mechanism, and finally in storing the pogo.
13. Obey all local traffic and pedestrian laws and regulations.
14. Watch out for pedestrians.
15. Check and secure all fasteners before every use.
16. Replace worn or broken parts immediately.
17. Do not make any modifications to the pogo.

REPLACEABLE PARTS

PART#	DESCRIPTION
PGBLT004-FLM1-GR	Red Grip
PGBLT004-FLM1-FP	Red Foot Pad
PGBLT004-FLT	Flint
PGBLT004-SPG	Flint Spring

SPARKING FLINT REPLACEMENT INSTRUCTIONS

1. Locate the spring-loaded flint holders in the sparking mechanism.

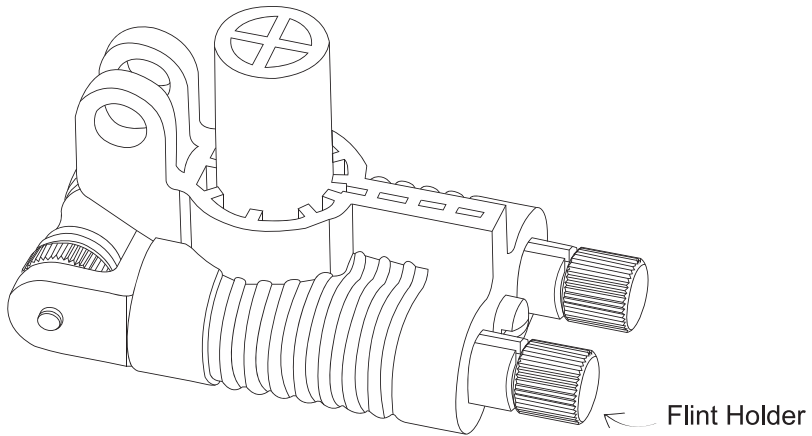

2. Push the tip toward the center of the pogo and twist the flint holder outwards to release it from the sparking mechanism.

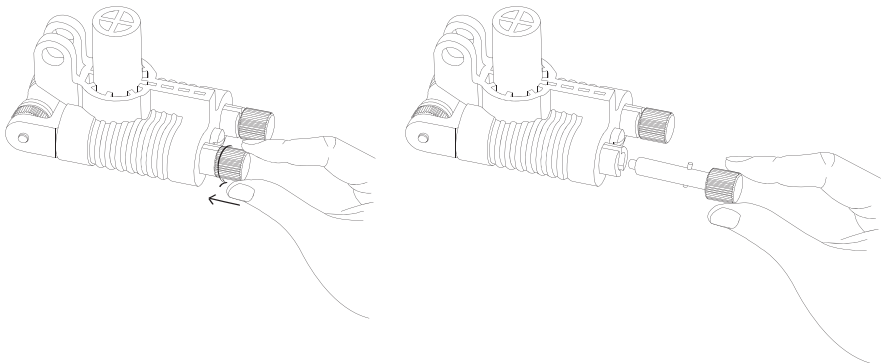

3. With the flint holder out, remove the used flint. Compress the flint spring with your fingers and ensure that it rebounds to the original length. If it stays compressed or becomes deformed, replace as necessary. Insert a new flint into the holder, then the flint spring, then the knob as shown in the diagram. Once everything is fully in the mechanism, push in and then twist inwards to lock the flint holder in place.

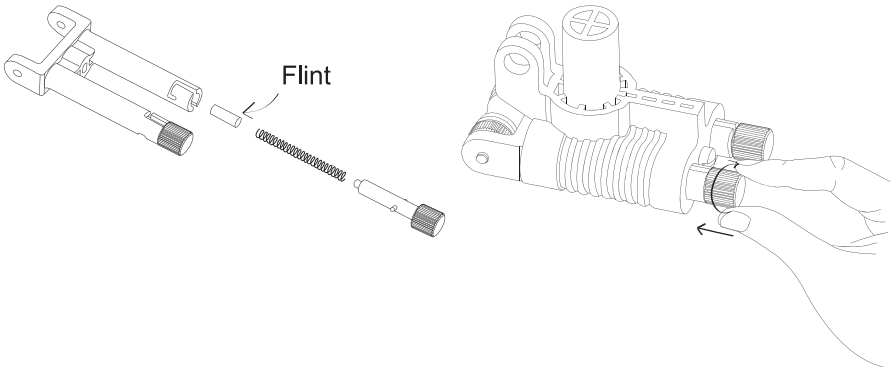

4. Repeat steps 1-3 for all other flints that need to be replaced.

MAINTENANCE

Keep this manual for future reference of assembly and product care. For general safety and maintenance, prior to each use the product should always be inspected for damaged or defective parts including:

- checking all nuts and bolts for tightness and tightening as needed
- checking that all spring-loaded joints are still intact and cannot become dislodged during play
- checking all coverings for any sharp edges and replacing when required
- checking that the grips, footpads, and sparking mechanisms are without defects

USING THE POGO

Your pogo is intended for outdoor use only. It should not be used indoors and is not intended to be used on soft (e.g. grass, dirt, snow, etc.) or inclined surfaces.

We strongly recommend that:

- the pogo is always used on a level surface
- the pogo is at least 6 ft. (2m) from any structure or obstruction such as furniture, walls, tables, lamps, etc.
- the pogo is not used with or within proximity of other play structures or toys

For maximum safety and fun, the follow tips below!

1. When jumping, stay vertical with your head and body directly over your feet.
2. The grips should always be used when jumping for added balance.
3. The pogo should not be pulled on, hung on, or used for any stunts or maneuvers.

WARRANTY



DO NOT RETURN TO STORE
Failure to follow these instructions may damage
your product and void your warranty.



Radio Road Limited Warranty:

Radio Road warrants that this product shall be free from defects in workmanship for one year from the day of purchase. If the product is defective, Radio Road's sole obligation under this warranty shall be at its election, subject to the terms of this warranty, to repair or replace any parts deemed defective. This warranty is for the exclusive benefit of the original purchaser and is not assignable or transferable. THIS WARRANTY IS MADE IN LIEU OF ALL OTHER WARRANTIES, EXPRESSED OR IMPLIED, AND ANY IMPLIED WARRANTIES, INCLUDING THE IMPLIED WARRANTIES OF MERCHANTABILITY AND FITNESS FOR A PARTICULAR PURPOSE, ARE LIMITED TO THE TERMS OF THIS WARRANTY, UNLESS OTHERWISE PROHIBITED BY LAW.

Exclusions

To the fullest extent permitted by law, Radio Road expressly disclaims and excludes from this warranty any liability for damages, including but not limited to general, special, indirect, incidental, consequential, aggravated, punitive or exemplary damages, and economic loss (even if Radio Road is informed of their possibility), third party claims against you, including for any loss or damages, and claims or damages related to loss of, or, damage to, your records or data. This warranty does not apply to any product the exterior of which has been damaged or defaced. This warranty will be voided by misuse, improper physical environment, improper repair, acts of God, war or terror, commercial use, and improper service, operation or handling.

Return Merchandise for Service

Any claim under this warranty must be made in writing to Radio Road, at the address provided by our technician, within 30 days after the owner discovers the circumstances giving rise to any such claim, and must include a copy of this warranty document, a receipt or copy of your invoice marked with the date of purchase and the original packaging. You may obtain service by calling the technician for a Return Merchandise Authorization (RMA) number. The RMA number must be prominently displayed on the outside of the shipping carton and the package must be mailed to Radio Road postage prepaid.

Radio Road
4720 Radio Road
Naples, Florida 34104
877-818-4221
www.radioroadtoys.com